

Boston Gear 700 Series Reducer Lubrication

This Service Bulletin addresses a lubrication problem that exists on Besser Skip Loaders which utilize the Boston Gear 700 Series Worm Gear Speed Reducers. The lubricant that was shipped with these machines, and that was previously recommended, was petroleum-based. This is incorrect. All #112674 reducers should use Mobile SHC-634/ISO-VG-450 Synthetic Lube Oil. Check the name/specification plate riveted to all reducers to make sure the correct oil is recommended (Inset A).

Also note that, even when using the synthetic oil, the 3/8" plastic breather plug that goes on the top of the Boston Gear 700 Series Reducer must be replaced with Part No. 90688 3/8" Street EL. The plastic breather plug should then be reinserted on the top of the Street EL (Inset B). This will correct any possible oil seepage.

This Service Bulletin corresponds with a field memo dated May 19, 1989, Subject: Reducer Lubrication, issued by the Besser Quality Assurance Manager.

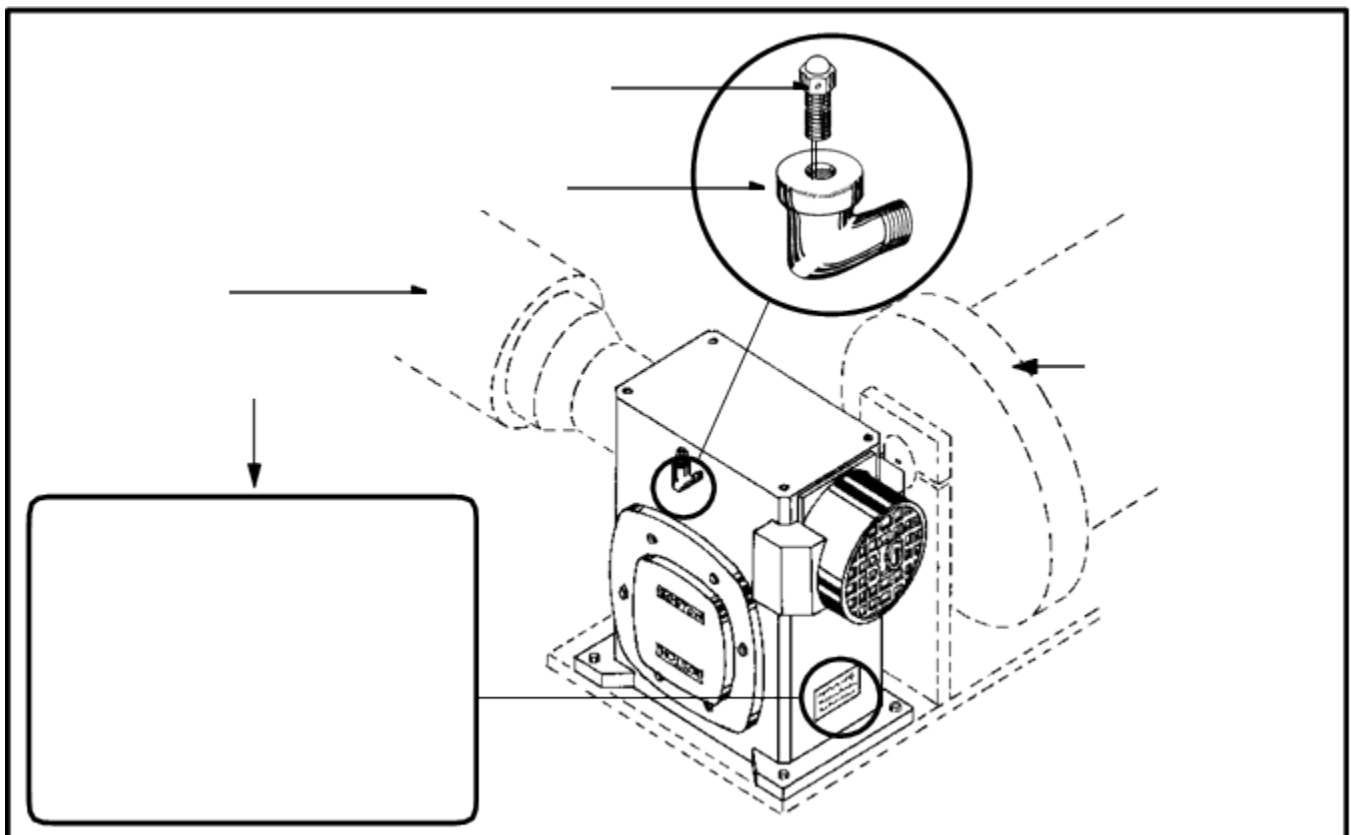

Boston Gear 700 Series Reducer Lubrication

SAFETY BULLETIN

This notice is issued to advise you that some previously accepted shop practices may not be keeping up with changing Federal and State Safety and Health Standards. Your current shop practices may not emphasize the need for proper precautions to insure safe operation and use of machines, tools, automatic loaders and allied equipment and/or warn against the use of certain solvents or other cleaning substances that are now considered unsafe or prohibited by law. Since many shop practices may not reflect current safety practice and procedures, particularly with regard to the safe operation of equipment, it is important that you review your practices to ensure compliance with Federal and State Safety and Health Standards.

IMPORTANT

The operation of any machine or power-operated device can be extremely hazardous unless proper safety precautions are strictly observed. Observe the following safety precautions:

ALWAYS:

- ✓ Be sure proper guarding is in place for all pinch, catch, shear, crush, and nip points.
- ✓ Be sure that all personnel are clear of the equipment before starting it.
- ✓ Be sure the equipment is properly grounded.
- ✓ Turn the main electrical panel off and lock it out in accordance with published lockout/tagout procedures prior to making adjustments, repairs, and maintenance.
- ✓ Wear appropriate protective equipment such as safety glasses, safety shoes, hearing protection, and hard hats.
- ✓ Keep chemical and flammable material away from electrical or operating equipment.
- ✓ Maintain a safe work area that is free from slipping and tripping hazards.
- ✓ Be sure appropriate safety devices are used when providing maintenance and repairs to all equipment.

Boston Gear 700 Series Reducer Lubrication

NEVER:

- ✓ Exceed the rated capacity of a machine or tool.
- ✓ Modify machinery in any way without prior written approval of the Besser Engineering Department.
- ✓ Operate equipment unless proper maintenance has been regularly performed.
- ✓ Operate any equipment if unusual or excessive noise or vibration occurs.
- ✓ Operate any equipment while any part of the body is in the proximity of potentially hazardous areas.
- ✓ Use any toxic flammable substance as a solvent cleaner.
- ✓ Allow the operation or repair of equipment by untrained personnel.
- ✓ Climb or stand on equipment when it is in operation.

It is important that you review Federal and State Safety and Health Standards on a continual basis. All shop supervisors, maintenance personnel, machine operators, tool operators, and any other person involved in the setup, operation, maintenance, repair or adjustment of Besser-built equipment should read and understand this bulletin and Federal and State Safety and Health Standards on which this bulletin is based.