

HEAVY-DUTY CORE COLLAPSING SUB-ASSEMBLY

PART NO. 3-301-571

12" - 21" diameter

TO ORDER:

Call: 515.432.3553

email: sales@besser.com

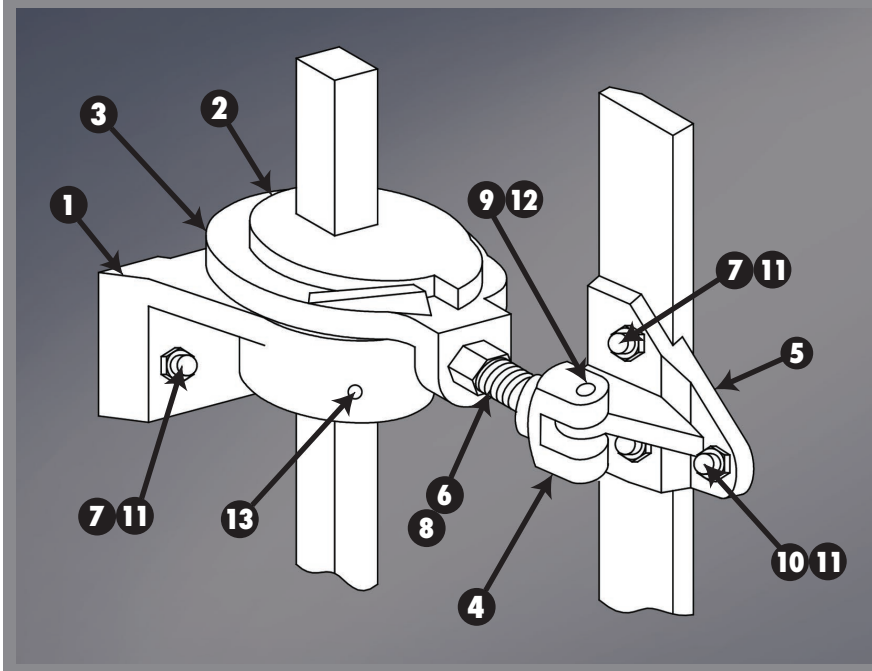

The Besser core collider is recognized throughout the precast industry for its simplicity, durability and efficiency

NO.	PART NO.	DESCRIPTION
1	3-301-569	Core fixture eccentric bearing B-51
2	3-301-567	Core fixture eccentric B-49
3	3-301-566	Core fixture eccentric collar B-48
4	3-301-562	Core fixture clevis R.H. B-38
5	3-301-568	Core fixture bracket B-50
6	3-301-557C	Core fixture adj. screw 5/8" x 2-1/2"
7	FHMS516-18X112	Flat head machine screw 5/16"-18 UNC x 1-1/2"
8	JN58-11	Hex jam nut 5/8"-11 UNC
9	HHCS38-16X2	Hex head cap screw 3/8"-16 UNC x 2"
10	FHMS516-18X114	Flat head machine screw 5/16"-18 UNC x 1-1/4"
11	EN516-18	Elastic nut 5/16"-18 UNC
12	EN38-16	Elastic nut 3/8"-16 UNC
13	CP14X214	Cotter pin 1/4" x 2-1/4"

0817-web

For better viewing, all guards, safety devices and signs are not necessarily shown. Some of the equipment shown or described throughout this brochure is available at extra cost. Besser Company reserves the right to change or improve product design and specifications without prior notice. Since the time of printing, some of the information in this brochure may have been updated, ask your Besser sales representative for details.

HEAVY-DUTY CORE COLLAPSING SUB-ASSEMBLY

PART NO. 3-301-570L

48" diameter and larger

TO ORDER:

Call: 515.432.3553

email: sales@besser.com

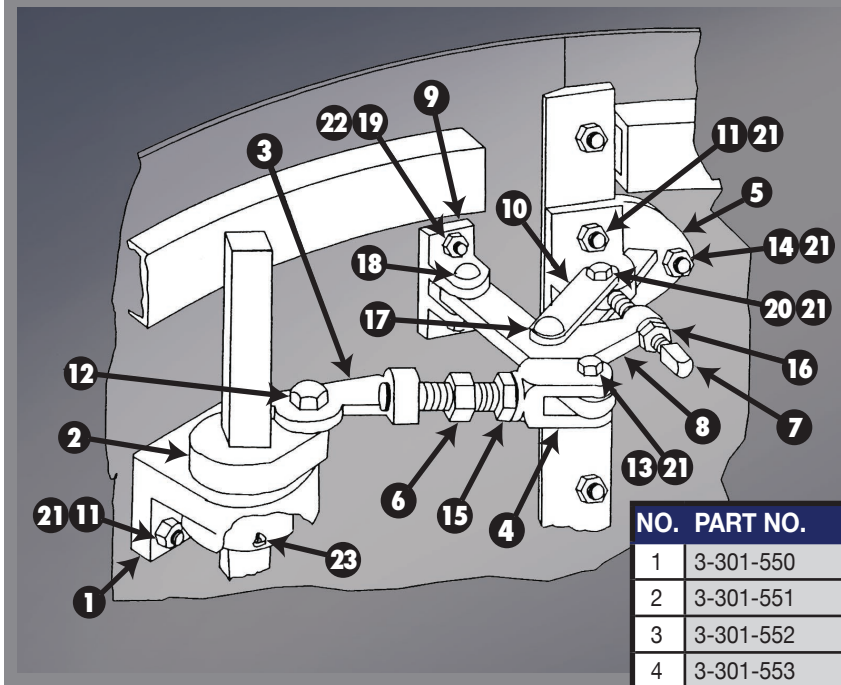

The Besser core collapser is recognized throughout the precast industry for its simplicity, durability and efficiency

NO.	PART NO.	DESCRIPTION
1	3-301-550	Core fixture eccentric bearing X-19
2	3-301-551	Core fixture eccentric X-20
3	3-301-552	Core fixture arm B-40
4	3-301-553	Core fixture clevis B-41
5	3-301-554	Core fixture bracket B-42
6	3-301-557A	Core fixture adj. screw 3/4" x 4-1/2"
7	SQHSS12-13X3CP	Square head set screw 1/2"-13 UNC x 3 (CP)
8	3-301-555	Core fixture fulcrum arm B-55
9	3-301-556	Core fixture fulcrum B-56
10	3-301-558B	Core fixture link 1/4" x 1" x 4-1/2"
11	FHMS12-13X134	Flat head machine screw 1/2"-13 UNC x 1-3/4"
12	HHCS58-11X112	Hex head cap screw 5/8"-11 UNC x 1-1/2"
13	HHCS12-13X214	Hex head cap screw 1/2"-13 UNC 2-1/4"
14	FHMS12-13X112	Flat head machine screw 1/2"-13 UNC x 1-1/2"
15	JN34-10	Hex jam nut 3/4"-10 UNC
16	JN12-13	Hex jam nut 1/2"-13 UNC
17	RHR12X112	Round head rivet 1/2" x 1-1/2"
18	RHR38X2	Round head rivet 3/8" x 2
19	FHMS38-16X114	Flat head machine screw 3/8"-16 UNC x 1-1/4"
20	HHCS12-13X2	Hex head cap screw 1/2"-13 UNC x 2
21	EN12-13	Hex elastic nut 1/2"-13 UNC
22	EN38-16	Hex elastic nut 3/8"-16 UNC
23	CP516X3	Cotter pin 5/16" x 3

0817-web

For better viewing, all guards, safety devices and signs are not necessarily shown. Some of the equipment shown or described throughout this brochure is available at extra cost. Besser Company reserves the right to change or improve product design and specifications without prior notice. Since the time of printing, some of the information in this brochure may have been updated, ask your Besser sales representative for details.

HEAVY-DUTY CORE COLLAPSING SUB-ASSEMBLY

PART NO. 3-301-570S

24" - 42" diameter

TO ORDER:

Call: 515.432.3553

email: sales@besser.com

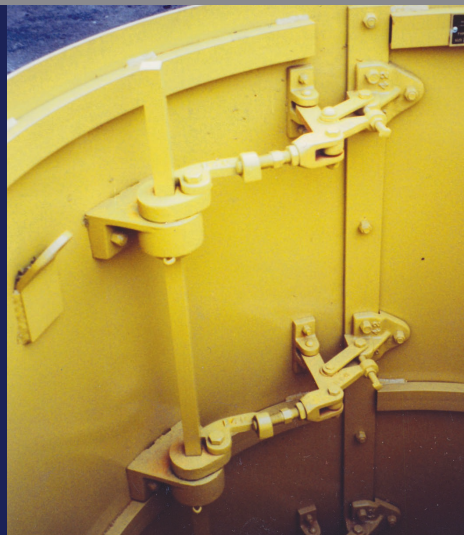
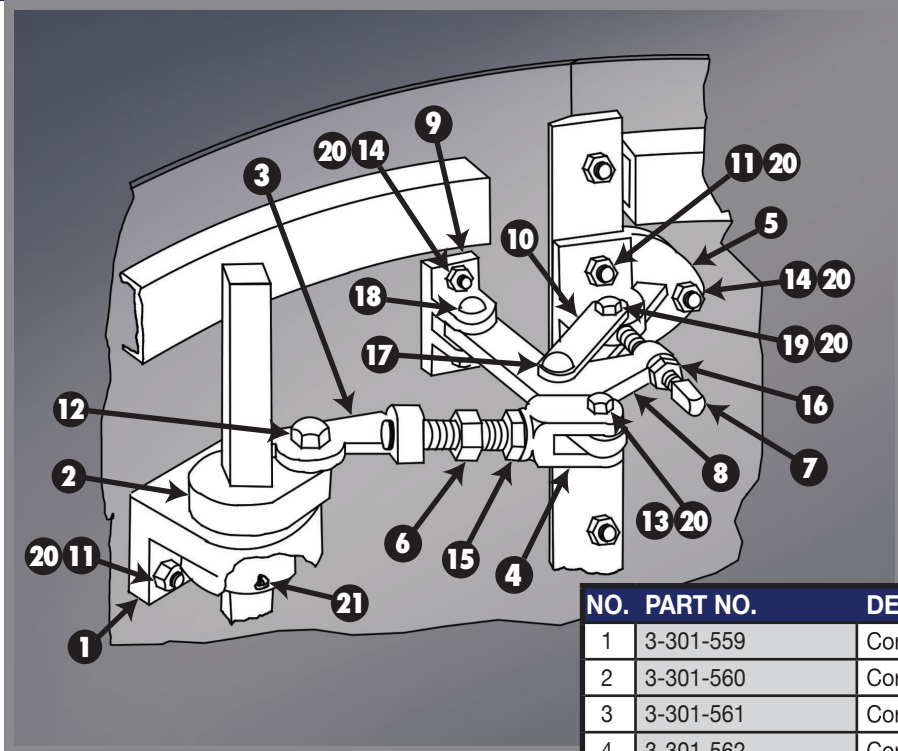

The Besser core collapser is recognized throughout the precast industry for its simplicity, durability and efficiency

NO.	PART NO.	DESCRIPTION
1	3-301-559	Core fixture eccentric bearing B-19
2	3-301-560	Core fixture eccentric B-20
3	3-301-561	Core fixture arm HB-37
4	3-301-562	Core fixture clevis B-38
5	3-301-563	Core fixture bracket B-39
6	3-301-557B	Core fixture adj. screw 5/8" x 3-1/2"
7	SQHSS12-13X212CP	Square head set screw 1/2"-13 UNC x 2-1/2" (CP)
8	3-301-564	Core fixture fulcrum arm B-53
9	3-301-565	Core fixture fulcrum B-54
10	3-301-558A	Core fixture link 1/4" x 1 x 3-1/2"
11	FHMS38-16X134	Flat head machine screw 3/8"-16 UNC x 1-3/4"
12	HHCS12-13X114	Hex head cap screw 1/2"-13 UNC x 1-1/4"
13	HHCS38-16X2	Hex head cap screw 3/8"-16 UNC x 2"
14	FHMS38-16X112	Flat head machine screw 3/8"-16 UNC x 1-1/2"
15	JN58-11	Hex jam nut 5/8"-11 UNC
16	JN12-13	Hex jam nut 1/2"-13 UNC
17	RHR38x138	Round head rivet 3/8" x 1-3/8"
18	RHR38X134	Round head rivet 3/8" x 1-3/4"
19	FHMS38-16X134	Flat head machine screw 3/8"-16 UNC x 1-3/4"
20	EN38-16	Hex elastic nut 3/8"-16 UNC
21	CP14x214	Cotter pin 1/4" x 2-1/4"

BESSER IS PRECAST

JACKET LOCK ASSEMBLY

PART NO. 3-301-724

TO ORDER:

Call: 515.432.3553
email: sales@besser.com

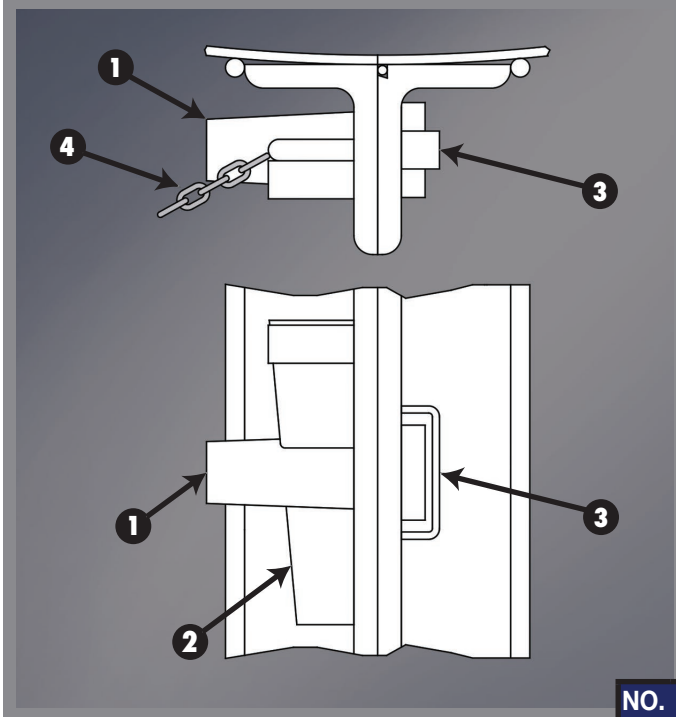

NO.	PART NO.	DESCRIPTION
1	3-301-639	Pin
2	3-301-640	Wedge
3	3-301-641	Keeper
4	Q53607	Chain, #2 machine x 10

0817-web

For better viewing, all guards, safety devices and signs are not necessarily shown. Some of the equipment shown or described throughout this brochure is available at extra cost. Besser Company reserves the right to change or improve product design and specifications without prior notice. Since the time of printing, some of the information in this brochure may have been updated, ask your Besser sales representative for details.

JACKET LOCK ASSEMBLY

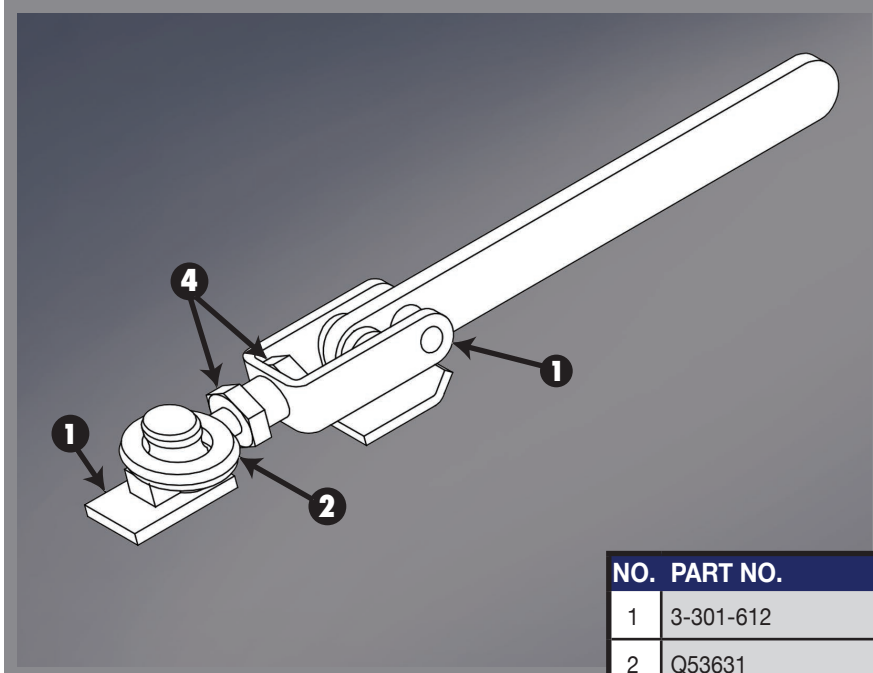

PART NO. 3-301-608
(complete JL-500 assembly)

PART NO. 3-301-608A
(less trunnion)

NO.	PART NO.	DESCRIPTION
1	3-301-612	Latch assembly
2	Q53631	Eye bolt 5/8"-18 UNF x 3-1/2"
3	3-301-607	Trunnion
4	JN58-18	Hex jam nut 5/8"-18 UNF

Note: Lock used without trunnion, use 3-301-608A

TO ORDER:

Call: 515.432.3553
email: sales@besser.com

BESSER IS PRECAST
BESSER IS PRECAST

JL-500S JACKET LOCK ASSEMBLY

BESSER IS PRECAST
BESSER IS PRECAST

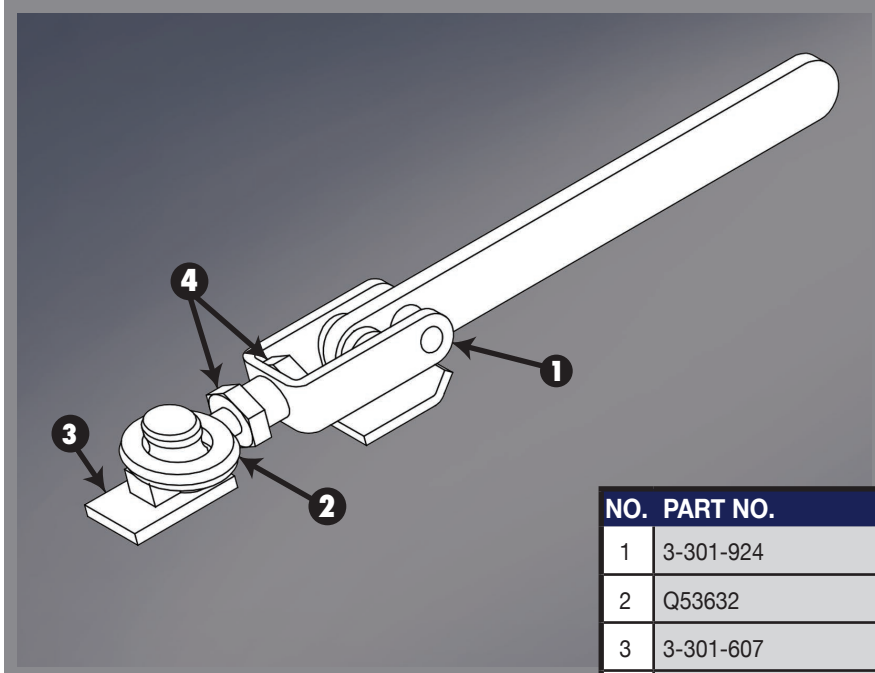

PART NO. 3-301-925
(complete JL-500S assembly)

PART NO. 3-301-925A
(less trunnion)

NO.	PART NO.	DESCRIPTION
1	3-301-924	Latch assembly
2	Q53632	Eye bolt 1/2"-20 UNF x 1-1/2"
3	3-301-607	Trunnion
4	JN12-20	Hex jam nut 1/2"-20 UNF

TO ORDER:

Call: 515.432.3553
email: sales@besser.com

0817-web

JL-507A JACKET LOCK ASSEMBLY

PART NO. 3-301-946

24" diameter and larger

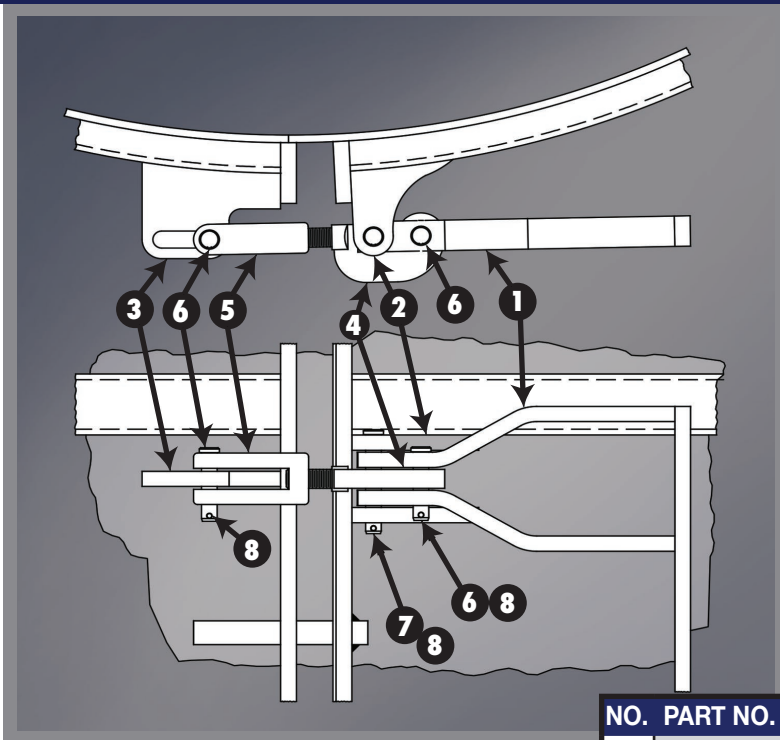

NO.	PART NO.	DESCRIPTION
1	3-301-949	Latch handle for JL-507A
2	3-301-1169	Jacket latch ear
3	3-301-1060	Jacket latch ear
4	3-301-940B	FL-507A draw rod
5	3-301-941A	JL-507A clevis
6	CLP12X2	Clevis pin 1/2" x 2"
7	CLP12X3	Clevis pin 1/2" x 3"
8	CP18X1	Cotter pin 1/8" x 1"

*Note: For 24" diameter and smaller, use 3-301-946S

TO ORDER:

Call: 515.432.3553
email: sales@besser.com

0817-web

For better viewing, all guards, safety devices and signs are not necessarily shown. Some of the equipment shown or described throughout this brochure is available at extra cost. Besser Company reserves the right to change or improve product design and specifications without prior notice. Since the time of printing, some of the information in this brochure may have been updated, ask your Besser sales representative for details.

JL-514 JACKET EXPANDER

PART NO. 3-301-757

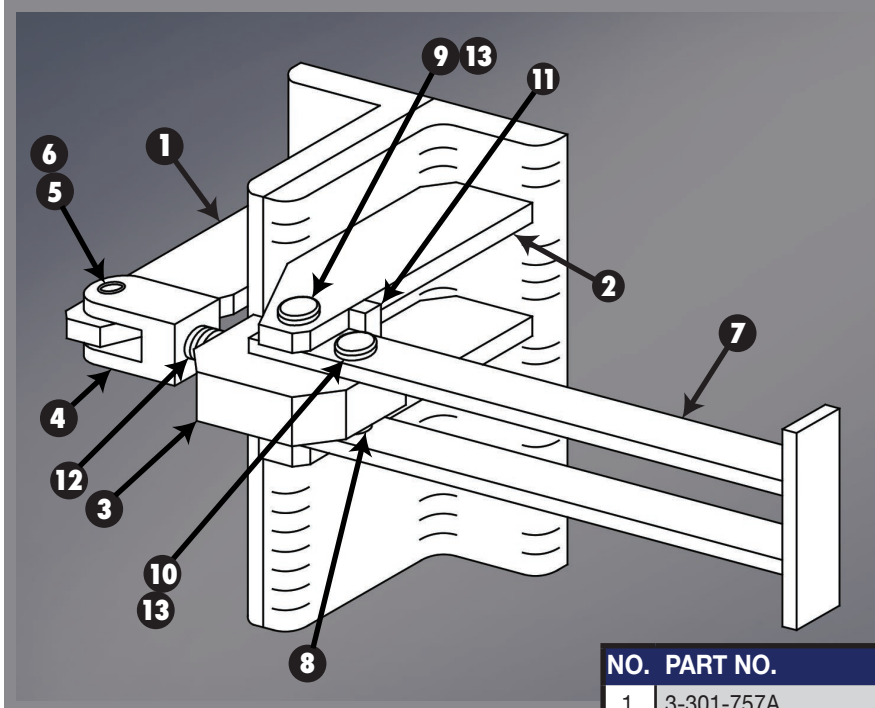

NO.	PART NO.	DESCRIPTION
1	3-301-757A	Clevis lug
2	3-301-757B	Handle lug
3	3-301-757C	Toggle
4	3-301-553	Core fixture clevis B-41
5	3-301-757D	Clevis pin
6	RP14X112	Roll pin 1/4" x 1-1/2"
7	3-301-757E	Handle assembly
8	FW58X134X134	Flat washer 5/8" x 1-3/4" O.D. x .134
9	CLP58X334	Clevis pin 5/8" x 3-3/4"
10	CLP58X234	Clevis pin 5/8" x 2-3/4"
11	3-301-757F	Handle stop
12	TR34-10	Threaded rod 3/4" - 10 UNC x 2-3/4"
13	CP316X114	Cotter pin 3/16" x 1-1/4"

TO ORDER:

Call: 515.432.3553
email: sales@besser.com

BESSER IS PRECAST
BESSER IS PRECAST

MACHINED CORE COLLAPSING SUB-ASSEMBLY

PART NO. 3-301-570LM

48" diameter and larger
8' and longer or special

TO ORDER:

Call: 515.432.3553

email: sales@besser.com

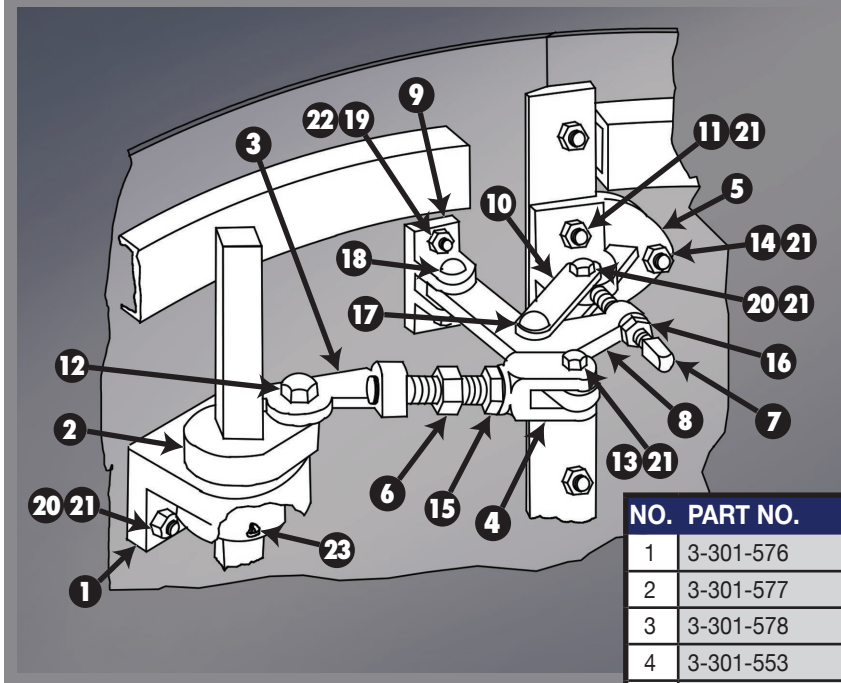

The Besser core collapser is recognized throughout the precast industry for its simplicity, durability and efficiency

NO.	PART NO.	DESCRIPTION
1	3-301-576	Core fixture eccentric bearing X-19A
2	3-301-577	Core fixture eccentric X-20A
3	3-301-578	Core fixture arm B-40A
4	3-301-553	Core fixture clevis B-41
5	3-301-554	Core fixture bracket B-42
6	3-301-557A	Core fixture adj. screw 3/4" x 4-1/2"
7	SQHSS12-13X3CP	Square head set screw 1/2"-13 UNC x 3 (CP)
8	3-301-582	Core fixture fulcrum arm B-55A
9	3-301-556	Core fixture fulcrum B-56
10	3-301-558C	Core fixture link 1/4" x 1 x 5-1/2"
11	FHMS12-13X134	Flat head machine screw 1/2"-13 UNC x 1-3/4"
12	HHCS58-11X112	Hex head cap screw 5/8"-11 UNC x 1-1/2"
13	HHCS12-13X214	Hex head cap screw 1/2"-13 UNC 2-1/4"
14	FHMS12-13X112	Flat head machine screw 1/2"-13 UNC x 1-1/2"
15	JN34-10	Hex jam nut 3/4"-10 UNC
16	JN12-13	Hex jam nut 1/2"-13 UNC
17	RHR12X112	Round head rivet 1/2" x 1-1/2"
18	RHR38X2	Round head rivet 3/8" x 2
19	FHMS38-16X114	Flat head machine screw 3/8"-16 UNC x 1-1/4"
20	HHCS12-13X2	Hex head cap screw 1/2"-13 UNC x 2
21	EN12-13	Hex elastic nut 1/2"-13 UNC
22	EN38-16	Hex elastic nut 3/8"-16 UNC
23	CP516X3	Cotter pin 5/16" x 3

0817-web

For better viewing, all guards, safety devices and signs are not necessarily shown. Some of the equipment shown or described throughout this brochure is available at extra cost. Besser Company reserves the right to change or improve product design and specifications without prior notice. Since the time of printing, some of the information in this brochure may have been updated, ask your Besser sales representative for details.

HEAVY-DUTY CORE COLLAPSING SUB-ASSEMBLY

PART NO. 3-301-570SM

24" - 42" diameter
8' and longer or special

TO ORDER:

Call: 515.432.3553
email: sales@besser.com

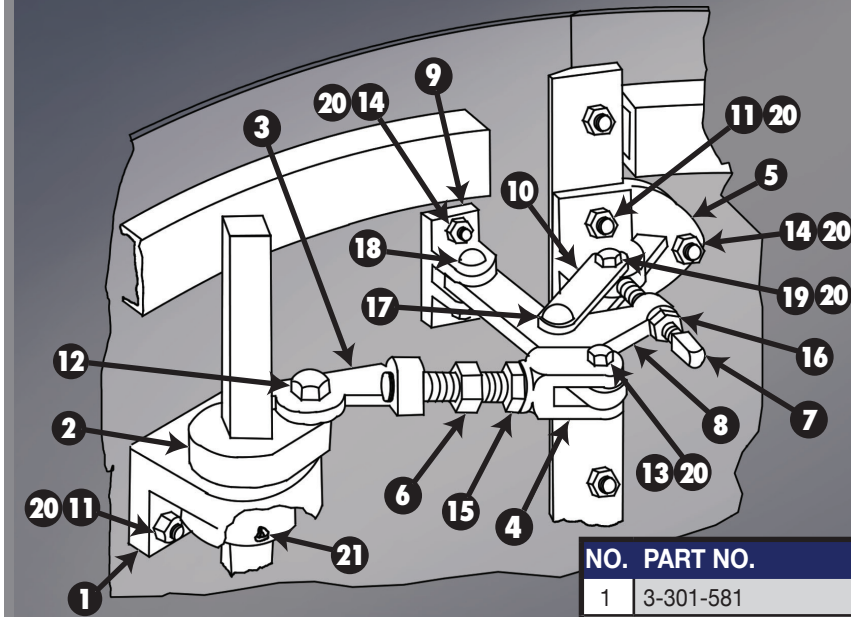

The Besser core collapser is recognized throughout the precast industry for its simplicity, durability and efficiency

NO.	PART NO.	DESCRIPTION
1	3-301-581	Core fixture eccentric bearing B-19A
2	3-301-579	Core fixture eccentric B-20A
3	3-301-580	Core fixture arm HB-37A
4	3-301-562	Core fixture clevis B-38
5	3-301-563	Core fixture bracket B-39
6	3-301-557B	Core fixture adj. screw 5/8" x 3-1/2"
7	SQHSS12-13X212CP	Square head set screw 1/2"-13 UNC x 2-1/2" (CP)
8	3-301-564	Core fixture fulcrum arm B-53
9	3-301-565	Core fixture fulcrum B-54
10	3-301-558A	Core fixture link 1/4" x 1 x 3-1/2"
11	FHMS38-16X134	Flat head machine screw 3/8"-16 UNC x 1-3/4"
12	HHCS12-13X114	Hex head cap screw 1/2"-13 UNC x 1-1/4"
13	HHCS38-16X2	Hex head cap screw 3/8"-16 UNC 2"
14	FHMS38-16X112	Flat head machine screw 3/8"-16 UNC x 1-1/2"
15	JN58-11	Hex jam nut 5/8"-11 UNC
16	JN12-13	Hex jam nut 1/2"-13 UNC
17	RHR38X138	Round head rivet 3/8" x 1-3/8"
18	RHR38X134	Round head rivet 3/8" x 1-3/4"
19	FHMS38-16X134	Flat head machine screw 3/8"-16 UNC x 1-3/4"
20	EN38-16	Hex elastic nut 3/8"-16 UNC
21	CP14X214	Cotter pin 1/4" x 2-1/4"

0719-web

For better viewing, all guards, safety devices and signs are not necessarily shown. Some of the equipment shown or described throughout this brochure is available at extra cost. Besser Company reserves the right to change or improve product design and specifications without prior notice. Since the time of printing, some of the information in this brochure may have been updated, ask your Besser sales representative for details.